

TIMELINE FOR CONSTRUCTION

Exhibit VIII. C.20.b

Access to the Sterling Forest Resort site will be provided off of Route 17A by two proposed entrances. The first entrance is a roundabout connecting 17A (four-lane, divided roadway east of the circle, two-lane undivided roadway west of the circle) and the proposed entrance drive to the Resorts World Grand Hotel (four-lane, undivided roadway). The second entrance is a signalized intersection including a left-turn lane into the Resorts World Grand Hotel site and an acceleration lane onto Route 17A from the Resorts World Grand Hotel site. To maintain traffic on Route 17A throughout the construction of the roundabout, several phases of construction will be implemented. All phases will comply with the current *Manual on Uniform Traffic Control Devices* (MUTCD), the New York State MUTCD supplement, and all other New York State Department of Transportation (NYSDOT) guidelines.

Roundabout Construction

Phase one includes necessary road widening to allow two lanes of traffic along the southern half of the roundabout. Both directions of traffic will be reduced to one lane and directed around the southern portion during the construction of the northern half. Phase two includes the completion of the roundabout construction where two-lane traffic will continue east off the roundabout.

Signalized Entrance Construction

The signalized entrance construction is split into three sections. (Figure VIII. C.20.b-1 Signalized Entrance Construction). Section A includes pavement widening for the addition of the left-turn lane and the acceleration lane. The existing road should be widened while maintaining one lane of traffic in each direction throughout construction. Section B will be a mill and overlay of the existing pavement while maintaining one lane of traffic open in each direction. Section C will include the removal of pavement and construction of new travel lanes while maintaining one lane of traffic in each direction.

Route 17a Widening

Other construction along Route 17A will include widening as necessary for turn lanes into proposed parking lots that service the New York Renaissance Fair and Ski Village. All work shall be completed while maintaining traffic open in each direction.

Figure VIII. C.20.b-1. Signalized Entrance Construction

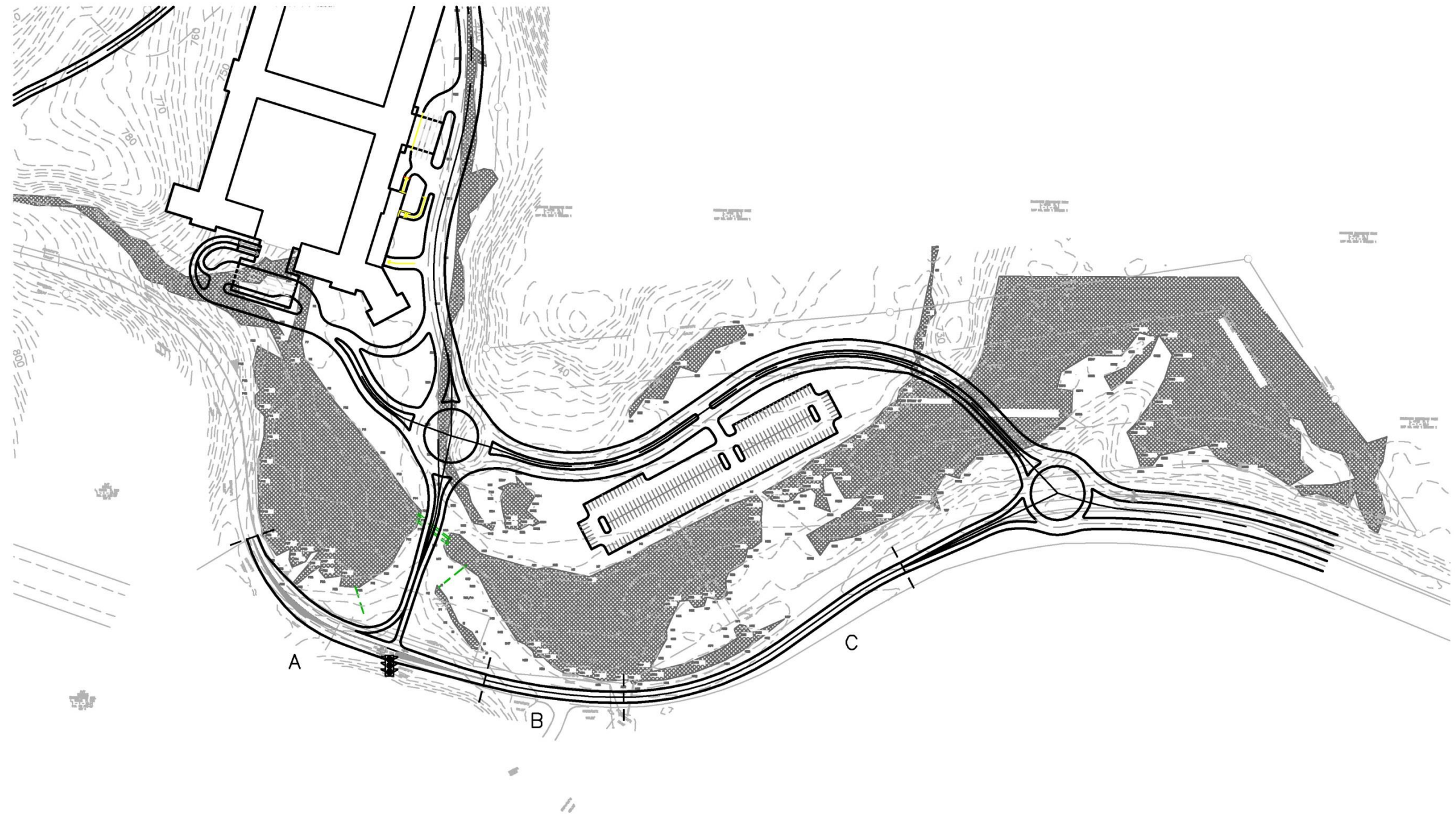

STERLING FOREST RESORTS
Tuxedo, NY



SIGNALIZED ENTRANCE
CONSTRUCTION
05.28.2014 Scale: 1"=200'
Kimley»Horn
of New York, P.C.

Figure VIII. C.20.b-2. Roundabout Construction

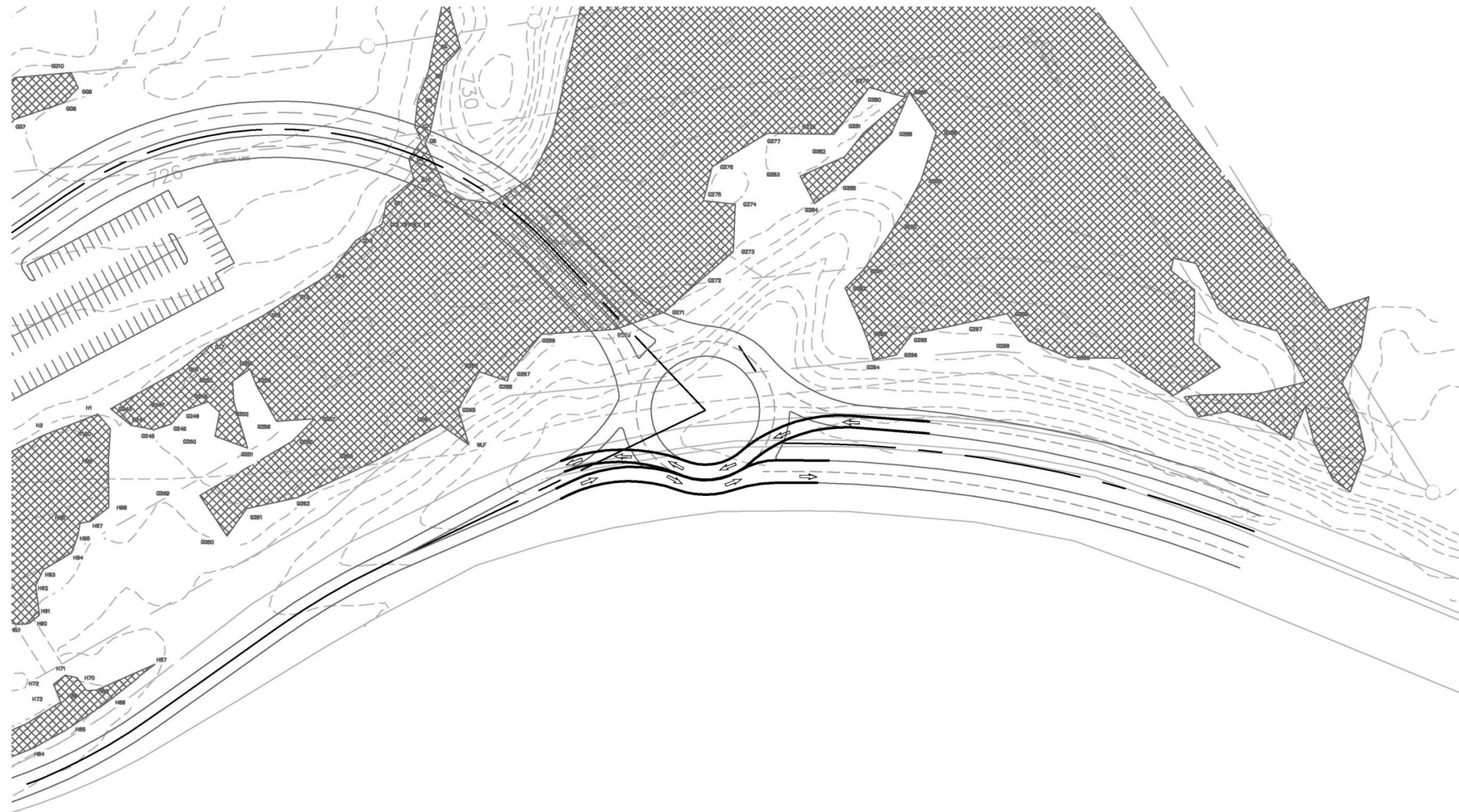

STERLING FOREST RESORTS
Tuxedo, NY



ROUNDOABOUT
CONSTRUCTION
05.28.2014 Scale: 1"=100'

Kimley»Horn
of New York, P.C.