

EXHIBIT **VIII.C.1.d.**

DIMENSIONS AND TOTAL ACREAGE



The site for the Applicant's proposed Gaming Facility is on a total of approximately 24 acres at 555 Broadway, Rensselaer, NY 12144. Attached to this exhibit is a boundary and dimensions map of the site. Please also refer to Exhibit VIII.C.1.a. for an aerial view of the site and boundary lines.

DEED REFERENCES:  
 1. CONVEYANCE TO MARX PROPERTIES, INC. BY DEED DATED APRIL 30, 2008 AND RECORDED IN THE RENSSELAER COUNTY CLERK'S OFFICE IN BOOK 4605 OF DEEDS AT PAGE 295.  
 2. CONVEYANCE TO MARX PROPERTIES, INC. BY DEED DATED APRIL 30, 2008 AND RECORDED IN THE RENSSELAER COUNTY CLERK'S OFFICE IN BOOK 4605 OF DEEDS AT PAGE 301.  
 MAP REFERENCES:  
 1. MAP ENTITLED "MAP OF VILLAGE OF GREENBUSH MADE FOR WILLIAM AKIN, TRUSTEES, GREENBUSH AND JOHN BECKERSON," DATED JUNE 1, 1810 SURVEYED BY EIGHT VAN ALLEN AND FILED IN THE OFFICE OF THE NEW YORK STATE OFFICE OF GENERAL SERVICES AS MAP No. 301.  
 2. MAP ENTITLED "FRESHWATER AND BULKHEAD LINES HUDSON RIVER, N.Y. WATERFORD TO HUDSON" SHEET 4 OF 14, DATED NOVEMBER 8, 1893 AND FILED IN THE OFFICE OF THE NEW YORK STATE OFFICE OF GENERAL SERVICES.  
 3. MAP ENTITLED "MAP 'X' AND MAP 'Y' IN THE APPLICATION OF SALVATORE ZAPPALÀ FOR A GRANT OF LANDS UNDER THE WATER OF HUDSON RIVER, CITY OF RENSSELAER, COUNTY OF RENSSELAER," DATED OCTOBER 1976, SURVEYED BY F. DWYER.  
 4. MAP ENTITLED "MAP OF PROPERTY TO BE CONVEYED TO RENSSELAER CITY SCHOOL DISTRICT," DATED DECEMBER 28, 1907 LAST REVISED ON FEBRUARY 3, 1994 BY EDWARD W. BOUTELLE AND SON.  
 5. MAP ENTITLED "MAP SHOWING SURVEY OF LANDS N/F OF RENSSELAER JUNIOR & SENIOR HIGH SCHOOL, RENSSELAER CITY SCHOOL DISTRICT, L. 1923 P. 845," DATED JANUARY 1904 LAST REVISED ON MARCH 10, 1904 BY AND ENGINEERS-SURVEYORS.

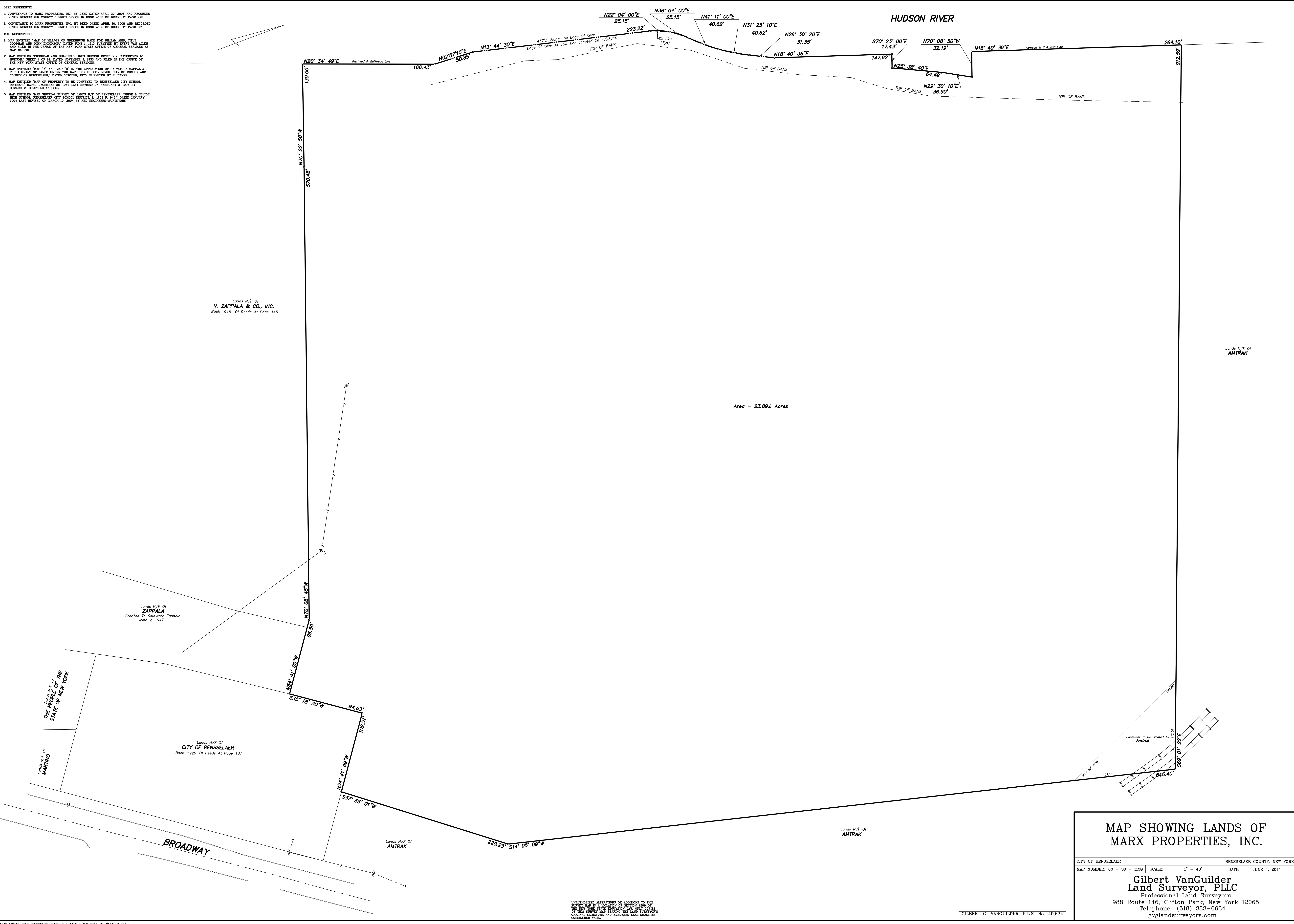

**MAP SHOWING LANDS OF MARX PROPERTIES, INC.**

CITY OF RENSSELAER	RENSSELAER COUNTY, NEW YORK
MAP NUMBER: 06 - 30 - 113Q	SCALE: 1" = 40'
DATE: JUNE 4, 2014	

**Gilbert VanGuilder**  
 Land Surveyor, PLLC  
 Professional Land Surveyors  
 988 Route 146, Clifton Park, New York 12065  
 Telephone: (518) 383-0634  
 gvglandsurveyors.com

GILBERT C. VANGUIDER, P.L.S. No. 49,824

UNAUTHORIZED ALTERATIONS OR ADDITIONS TO THIS SURVEY MAP IS A VIOLATION OF SECTION 2006 OF THE NEW YORK STATE EDUCATION LAW. ONLY COPIES OF THIS SURVEY MAP BEARING THE LAND SURVEYOR'S ORIGINAL SIGNATURE AND EMPRESSED SEAL SHALL BE CONSIDERED VALID.