

## EXHIBIT VIII.C.6.a – Description of Proposed Gaming Area

*Submit as Exhibit VIII.C.6.a, a description of the proposed gaming area (or areas, if more than one is being considered). The description should include, but not be limited to, the following:*

### 1. Square footage of each sub-area and a total for all gaming space:

The gaming floor will consist of approximately 60,000 square feet, which includes 56,000 square feet of main gaming floor and a VIP gaming area that will consist of approximately 4,000 square feet of gaming space.

### 2. Total number of planned table games, with a breakdown by game type and number of positions per table:

a. Total Number of Planned Games: 56

b. Breakdown by Game Type and Number of Positions per Table

- Blackjack: 28 tables with 6 positions per table
- Craps: 4 tables with +/- 12 positions per table
- Roulette: 4 tables with 8 positions per table
- Mini-Baccarat: 5 tables with 6 positions per table
- Poker-Derivative Games (including Three Card Poker, Pai Gow, Ultimate Texas Hold 'Em, etc.): 15 tables with 6 positions per table

### 3. Total number of slot machines: 1,506

### 4. Number and description of other electronic gaming devices or specialty games being considered:

Electronic table games such as Blackjack, Craps, and Roulette will be considered as will other approved games brought to market prior to the opening of the casino.

### 5. Description of any special purpose rooms that are being considered (e.g., poker rooms, high-limit gaming areas, etc.):

Capital View Casino & Resort will feature an upscale high-limit slot and table games experience for our top-tier guests. It will include 8 tables including baccarat and blackjack. The luxury high-limit gaming area will include approximately 58 slots in denominations that range from \$.01 to \$100. An adjacent members-only lounge will provide our best guests with a place to relax, rejuvenate, and socialize with other VIP players.

### 6. Layout of cage area, including number of windows, and a breakdown of special use windows, if any:

The cage shall be designed and constructed to provide security for the materials housed therein and the activities performed therein such as being fully enclosed except for openings through which materials such as cash, records, and documents can be passed to service guests and Team Members.

The cage area will consist of the following:

- 4 cashier windows to service casino guests and one cashier window to service employees. A minimum of one window will be designed to process check cashing functions.



## EXHIBIT VIII.C.6.a – Description of Proposed Gaming Area

Submit as Exhibit VIII.C.6.a, a description of the proposed gaming area (or areas, if more than one is being considered). The description should include, but not be limited to, the following:

- Discrete panic alarms at each station that are directly connected to the surveillance room to alert the surveillance team in the event there is any security threat.
- Surveillance coverage capable of monitoring and recording with sufficient clarity to permit identification of each employee and his movements and to permit identification of all currency, coins, and paperwork occurring in the cage. Coverage includes all Cashier stations, including counters, customer windows, employee windows, cash drawers, vaults, safes and chip and token storage areas.
- Door monitoring via an Electronic Access Identification and Control System which creates an event log of doors opened by use of the identification card or badge upon the request of the Surveillance Department. The system displays the photograph of the employee swiping an access controlled door. Furthermore, a visual alarm notifies Surveillance upon any unauthorized access swipes.
- Secured entry and exit via man trap (double metal door) access configuration that shall not permit a person to pass through the second door until the first door is securely locked.
- Back-up access lockout system via keyed security locks on each metal door of the man trap entry system - the keys to which shall be different from each other.
- Cash/chip trays or carts for each work station that are under dedicated surveillance coverage.
- Computers at each work station.
- Phone access at each station.
- Networked printer.
- Storage for materials and supplies.
- Cashier balancing station with counter made of see through acrylic glass.

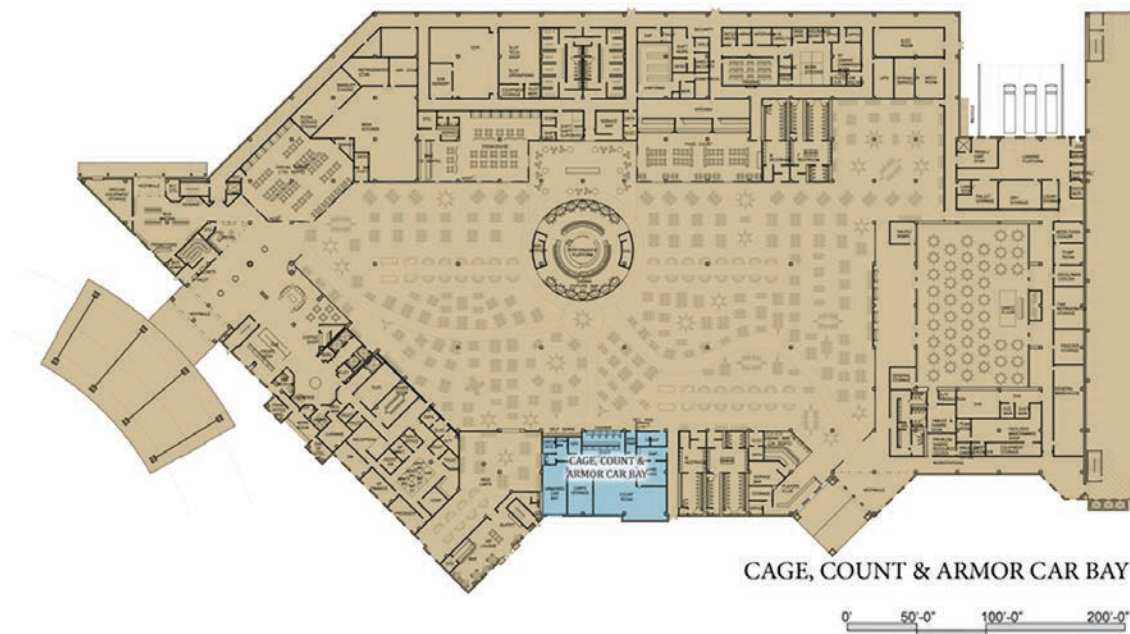

## EXHIBIT VIII.C.6.a – Description of Proposed Gaming Area

Submit as Exhibit VIII.C.6.a, a description of the proposed gaming area (or areas, if more than one is being considered). The description should include, but not be limited to, the following:

### 7. Description of size, layout, and location of count room:

The count room is a 1,200 square foot, highly secured room located behind the main cashier complex and adjacent to the cart storage room and armored car bay.

The count room will consist of the following:

- Secured entry and exit via man trap (double metal door) access configuration that shall not permit a person to pass through the second door until the first door is securely locked.
- Back-up access lockout system via keyed security locks on each metal door of the man trap entry system - the keys to which shall be different from each other.
- Door monitoring via an Electronic Access Identification and Control System which audibly signals the surveillance room and creates an event log of doors opened by use of the identification card or badge upon the request of the Surveillance Department. The system displays the photograph of the employee swiping an access controlled door. Furthermore, a visual alarm notifies surveillance upon any unauthorized access swipes.
- Audio and video surveillance coverage capable of monitoring and recording with sufficient clarity to permit identification of each employee and his movements and to permit identification of all currency, coins, and paperwork occurring in the count room.
- A fixed door type or hand-held metal detector which shall be used to inspect all persons prior to entry.
- Tables constructed of clear lexan/plexy material.
- Large currency sorter machine(s).
- Metal carts/cages for transport/storage of bill validator (cash) boxes.
- Acrylic glass supply storage cabinet.
- Acrylic glass work tables to facilitate the work flow as the bill validator boxes are opened, emptied, verified, and counted.
- Secure, bank-style pass-thru window to the main bank for transfer of funds.
- Networked computer.
- Telephone.

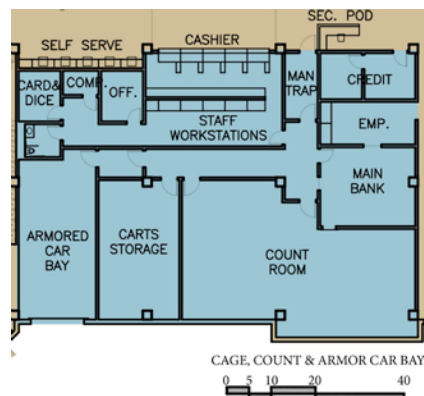

## EXHIBIT VIII.C.6.a – Description of Proposed Gaming Area

---

*Submit as Exhibit VIII.C.6.a, a description of the proposed gaming area (or areas, if more than one is being considered). The description should include, but not be limited to, the following:*

**8. Layout of any players club areas, include number of stations, location, etc.:**

The Player's Club will be located immediately inside the casino entrance closest to the parking garage for the highest visibility. The Player's Club will feature a minimum of 4 work stations with one designed to accommodate handicap guests. The Player's Club will be designed to accommodate all traditional Player's Club transactions including event sign-up and gift distribution.

**9. Include a description of any other gaming related amenities that are not included in this section, but are relevant to operation:**

- Capital View Casino & Resort will have a private area to discuss and establish casino credit with guests
- Capital View Casino & Resort will have a special motor coach receiving area to facilitate the arrival of regional and out-of-state groups.
- Capital View Casino & Resort will offer transportation services to our better players.
- See also the VIP programs and amenities detailed in Exhibit VIII.C.6.b.

**10. If the plan is to build the facility in different phases, the information provided should be broken out to explain the details of each phase, and then the Applicant should show a final description of the finished product. All descriptions should include plans created with a Computer Aided Design type of software.**

N/A

