

EXHIBIT VIII.C.13 – Back of House

Submit as Exhibit VIII.C.13. a description, including square footage, of back of house, security, kitchen and office facilities to support the remaining building program.

Please see Attached Table VIII.C.13 indicating the current, anticipated spaces in detail.

We recognize the importance of striking the right balance of support spaces required to promote efficient and effective support operations for our public activities. Critical to successful support facilities layouts are proximity, simplicity and accessibility to Team members, but obscurity and security from the public. The configuration is extremely efficient and BOH circulation is simple and well connected. Our Team members will enjoy services such as dining and break rooms and many will have their uniforms cared for on property. Human Resources is immediately adjacent to Team member service areas.

The Diagram below identifies the back of house areas illustrated in blue.

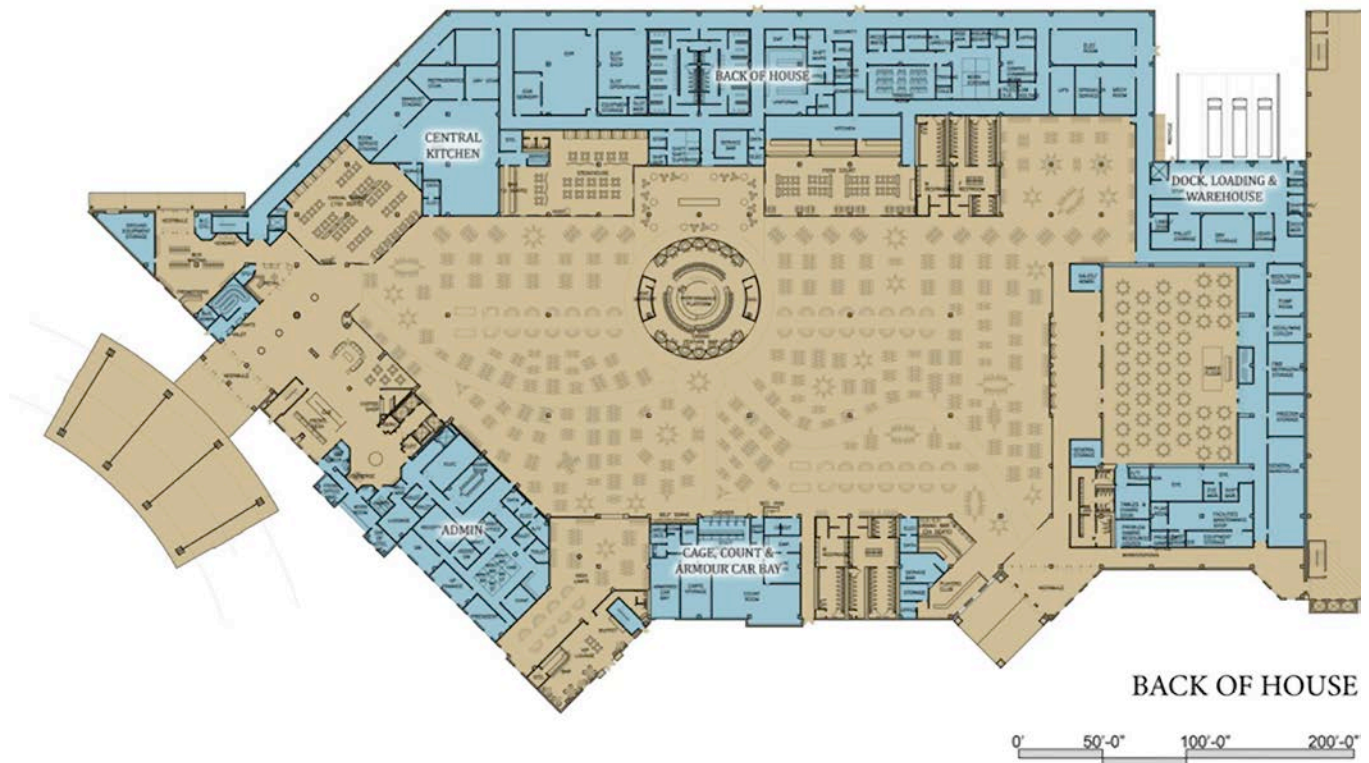

EXHIBIT VIII.C.13 – Back of House

Submit as Exhibit VIII.C.13. a description, including square footage, of back of house, security, kitchen and office facilities to support the remaining building program.

BACK OF HOUSE

Space	Qty : Unit	S.F. / Unit	Area	Total
Security				940 s.f.
Security Command	1 Area	120	120	
Director Security	1 Office	120	120	
Office 2	1 Office	100	100	
Shift Managers	1 Office	200	200	
Holding Room	1 Room	100	100	
Card/Dice Destruction	1 Room	100	100	
Restroom	1 Room	50	50	
EMT	1 Area	150	150	
Security Sub-Total				940 s.f.
Net / Gross Factor	@	30%		280 s.f.
Security Total				1,200s.f.
Surveillance				1,670
Director	1 Office	120	120	
Monitor Room	1 Area	1,000	1,000	
Equipment Room	1 Area	200	200	
Surveillance Racks	1 Area	200	200	
Tape Review	1 Room	150	150	
Surveillance Sub-Total				1,670 s.f.
Net / Gross Factor	@	30%		500 s.f.
Surveillance Total				2,200s.f.
Slot Operations				2,500 s.f.
Manager Office	1 Office	100	100	
Slot Tech Shop	1 Area	2,000	2,000	
Equipment Storage	1 Area	400	400	
Slot Operations Sub-Total				2,500 s.f.
Net / Gross Factor	@	20%		500 s.f.
Slot Operations Total				3,000s.f.



EXHIBIT VIII.C.13 – Back of House

Submit as Exhibit VIII.C.13. a description, including square footage, of back of house, security, kitchen and office facilities to support the remaining building program.

Space	Qty : Unit	S.F. / Unit	Area	Total
NY Gaming Commission				500 s.f.
Office	1 Area	100	100	
Workstation	1 Area	300	300	
Communications Rm	1 Rm	100	100	
NY Gaming Commission Sub-Total				500 s.f.
Net / Gross Factor	@ 30%			150 s.f.
NY Gaming Commission Total				700 s.f.
Problem Gambling Resource Center				400 s.f.
Office	1 Area	100	100	
Workstation	1 Area	300	300	
Problem Gambling Resource Center Sub-Total				400 s.f.
Net / Gross Factor	@ 30%			120 s.f.
Problem Gambling Resource Center Total				500 s.f.
Administration				
Executive Offices				1,440 s.f.
Reception Area	1 Areas	240	240	
President	0 Offices	240	0	
VP Finance	1 Office	240	240	
General Manager	1 Office	240	240	
Assistant GM	1 Office	150	150	
Staff Workstations	2 Cubicles	60	120	
Board Room	1 Rooms	400	400	
Restroom	1 Rooms	50	50	
Marketing				2,380 s.f.
VP Marketing	1 Office	120	120	
VP Casino Marketing	1 Office	120	120	
Marketing Offices	2 Offices	100	200	
Staff Workstations	5 Cubicles	60	300	
Conference Room	1 Rooms	200	200	
Director Slots	1 Office	120	120	
Director Table Games	1 Office	120	120	
Promotions	1 Office	120	120	
Shift Managers	1 Areas	240	240	
Staff Workstations	14 Cubicles	60	840	
Casino				
VP Gaming	2 Offices	120	240	
Shift Supervisor	1 Office	120	120	
Staff Workstations	6 Cubicles	60	360	
Storage	1 Rooms	100	100	



EXHIBIT VIII.C.13 – Back of House

Submit as Exhibit VIII.C.13. a description, including square footage, of back of house, security, kitchen and office facilities to support the remaining building program.

Space	Qty : Unit	S.F. / Unit	Area	Total
Finance & Accounting				1,880 s.f.
Director	1 Office	120	120	
Controller	1 Office	100	100	
Compliance	1 Office	100	100	
Internal Audit	1 Office	100	100	
Risk Manager	1 Office	100	100	
Enclosed Offices	4 Offices	100	400	
Workstations	14 Cubicles	60	840	
Conference Room	1 Room	120	120	
Food & Beverage Administration				1,100 s.f.
VP Food & Beverage	1 Office	120	120	
Enclosed Offices	5 Offices	100	500	
Workstations	8 Cubicles	60	480	
Information Technologies				1,830 s.f.
IT Director	3 Offices	120	360	
IT Lab	1 Area	400	400	
IT Racks	1 Room	500	500	
PBX Manager	1 Office	120	120	
PBX	1 Area	300	300	
Supplies	1 Room	150	150	
Human Resources				1,730 s.f.
Reception / Waiting	1 Area	120	120	
VP H. R.	1 Office	180	180	
H. R. Director	1 Office	180	180	
Insurance Benefits	1 Office	100	100	
Hiring	1 Office	100	100	
Training	1 Office	100	100	
Interviewing	1 Room	150	150	
Enclosed Offices	1 Office	100	100	
Staff Workstations	10 Areas	60	600	
Restrooms	2 Rooms	50	100	
Misc. Administration				1,320 s.f.
Copy / Storage	1 Room	150	150	
Files	1 Room	300	300	
Work / Mail Room	1 Room	150	150	
Conference Room	1 Room	300	300	
Restrooms	2 Rooms	150	300	
Kitchenette	1 Area	120	120	
Administrative Services Sub-Total				11,680 s.f.
Net / Gross Factor	@	25%		2,920 s.f.
Administrative Services Total				14,600s.f.



EXHIBIT VIII.C.13 – Back of House

Submit as Exhibit VIII.C.13. a description, including square footage, of back of house, security, kitchen and office facilities to support the remaining building program.

Space	Qty : Unit	S.F. / Unit	Area	Total
Employee Services				
Employee Facilities				3,000 s.f.
Changing Area	2 Rooms	800	1,600	
Restrooms	2 Rooms	400	800	
Lockers Area	1 Area	600	600	
Employee Services Sub-Total				3,000 s.f.
Net / Gross Factor	@	30%		900 s.f.
Employee Services Total				3,900s.f.
Conference / Training Room				2,120 s.f.
Training Room	1 Room	2,000	2,000	
AV/Closet	1 Room	40	40	
Storage Room	1 Room	80	80	
Conference / Training Sub-Total				2,120 s.f.
Net / Gross Factor	@	10%		210 s.f.
Conference/Training Total				2,300s.f.
Uniforms				2,200 s.f.
Manager Office	1 Office	100	100	
Uniform Room	1 Room	2,000	2,000	
Uni. Care / Seamstress	1 Area	200	200	
Uniforms Sub-Total				2,200 s.f.
Net / Gross Factor	@	25%		550 s.f.
Uniforms Total				2,800s.f.
Employee Dining Room				3,500 s.f.
Dining Area	200 Seats	15	3,000	
Servery	1 Area	500	500	
Employee Dining Sub-Total				3,500 s.f.
Net / Gross Factor	@	15%		530 s.f.
Employee Dining Total				4,000s.f.

